

PRO 55 TRIM

LED Recessed downlight

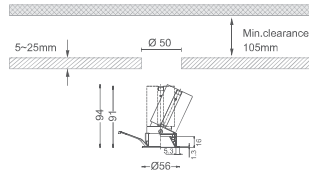

Colour(Front ring)

- WHITE Standard Non-standard
- BLACK Standard Non-standard

IP rate

- IP20 Standard Non-standard
- IP54 Standard Non-standard

CCT

- 2700K Standard Non-standard
- 3000K Standard Non-standard
- 3500K Standard Non-standard
- 4000K Standard Non-standard
- 5000K Standard Non-standard
- 2700-6000K Non-standard
- 1800-4000K Non-standard
- DTW 1800-3000K Non-standard

Control

- ON/OFF Standard Non-standard
- DALI Standard Non-standard
- 0/1-10V Standard Non-standard
- TRIAC Non-standard
- BLUETOOTH Non-standard
- ZIGBEE Non-standard
- CASAMBI Non-standard

Optical Accessories

When E01 is selected, the protection level is IP20;
Choosing E02, E03, or E04 can achieve IP54 protection level;
You can choose one or both: E01+E02, E01+E03, or E01+E04.

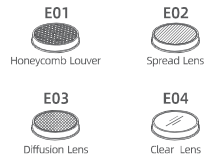

LED 4.5W/6.5W/8W (CITIZEN LED)

LED Power	System Power	LED Output	System Output	Beam	CCT	CRI	Drive
6.5W	7W	660lm	467lm	15°	3000K	> 90	34V 200mA
6.5W	7W	652lm	596lm	24°	3000K	> 90	32V 200mA
6.5W	7W	652lm	626lm	36°	3000K	> 90	32V 200mA
6.5W	7W	652lm	570lm	45°	3000K	> 90	32V 200mA
8W	9W	792lm	600lm	15°	3000K	> 90	34V 250mA
8W	9W	815lm	678lm	24°	3000K	> 90	32V 250mA
8W	9W	815lm	717lm	36°	3000K	> 90	32V 250mA
8W	9W	815lm	667lm	45°	3000K	> 90	32V 250mA

Light Distribution

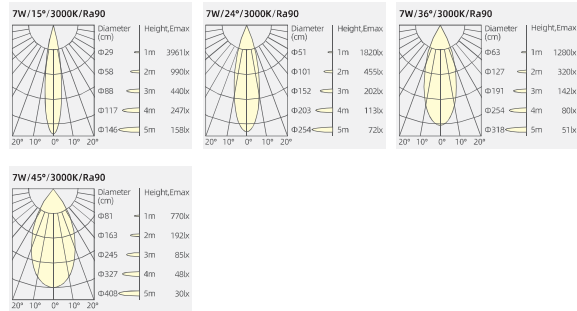

Colour(Reflector)



LED Recessed downlight

PRO 55 TRIM

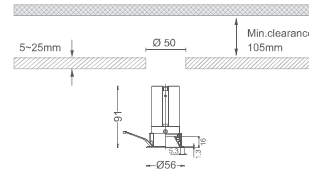

Colour(Front ring)

- WHITE Standard Non-standard
- BLACK Standard Non-standard

IP rate

- IP20 Standard Non-standard
- IP54 Standard Non-standard

CCT

- 2700K Standard Non-standard
- 3000K Standard Non-standard
- 3500K Standard Non-standard
- 4000K Standard Non-standard
- 5000K Standard Non-standard
- 2700-6000K Non-standard
- 1800-4000K Non-standard
- DTW 1800-3000K Non-standard

Control

- ON/OFF Standard Non-standard
- DALI Standard Non-standard
- 0/1-10V Standard Non-standard
- TRIAC Non-standard
- BLUETOOTH Non-standard
- ZIGBEE Non-standard
- CASAMBI Non-standard

Optical Accessories

When E01 is selected, the protection level is IP20;
Choosing E02, E03, or E04 can achieve IP54 protection level;
You can choose one or both: E01+E02, E01+E03, or E01+E04.

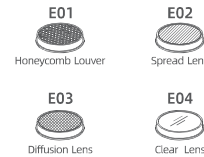

LED 4.5W/6.5W/8W (CITIZEN LED)

LED Power	System Power	LED Output	System Output	Beam	CCT	CRI	Drive
6.5W	7W	660lm	467lm	15°	3000K	> 90	34V 200mA
6.5W	7W	652lm	596lm	24°	3000K	> 90	32V 200mA
6.5W	7W	652lm	626lm	36°	3000K	> 90	32V 200mA
6.5W	7W	652lm	570lm	45°	3000K	> 90	32V 200mA
8W	9W	792lm	600lm	15°	3000K	> 90	34V 250mA
8W	9W	815lm	678lm	24°	3000K	> 90	32V 250mA
8W	9W	815lm	717lm	36°	3000K	> 90	32V 250mA
8W	9W	815lm	667lm	45°	3000K	> 90	32V 250mA

Light Distribution

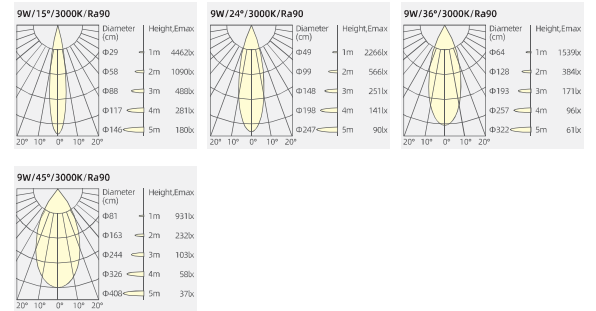

Colour(Reflector)

