

PRO 60 TRIM

LED Recessed downlight

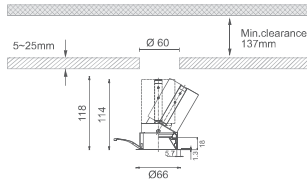

Colour(Front ring)

- Standard
- Non-standard
- WHITE
- BLACK

IP rate

- Standard
- Non-standard
- IP20
- IP54

CCT

- Standard
- Non-standard
- 2700K
- 3000K
- 3500K
- 4000K
- 5000K
- 2700-6000K
- 1800-4000K
- DTW 1800-3000K

Control

- Standard
- Non-standard
- ON/OFF
- DALI
- 0/1-10V
- TRIAC
- BLUETOOTH
- ZIGBEE
- CASAMBI

Optical Accessories

When E01 is selected, the protection level is IP20;
Choosing E02, E03, or E04 can achieve IP54 protection level;
You can choose one or both: E01+E02, E01+E03, or E01+E04.

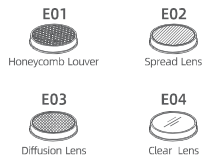

LED 10W/12W (CITIZEN LED)

LED Power	System Power	LED Output	System Output	Beam	CCT	CRI	Drive
9.5W	10.5W	951lm	639lm	15°	3000K	> 90	32V 300mA
10W	11.5W	1320lm	843lm	24°	3000K	> 90	34V 300mA
10W	11.5W	1320lm	976lm	36°	3000K	> 90	34V 300mA
10W	11.5W	1320lm	905lm	45°	3000K	> 90	34V 300mA
10W	11.5W	1320lm	885lm	55°	3000K	> 90	34V 300mA
11.5W	12.5W	1087lm	695lm	15°	3000K	> 90	32V 350mA
12W	14W	1650lm	1037lm	24°	3000K	> 90	34V 350mA
12W	14W	1650lm	1142lm	36°	3000K	> 90	34V 350mA
12W	14W	1650lm	1116lm	45°	3000K	> 90	34V 350mA
12W	14W	1650lm	1082lm	55°	3000K	> 90	34V 350mA

Light Distribution

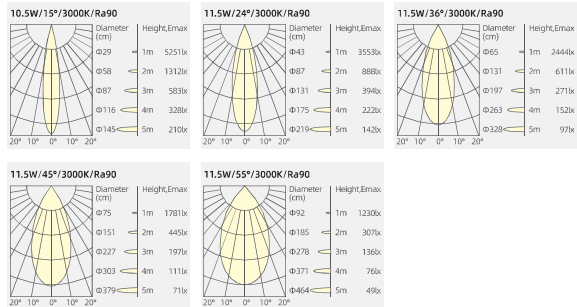

Colour(Reflector)



LED Recessed downlight

PRO 60 TRIM

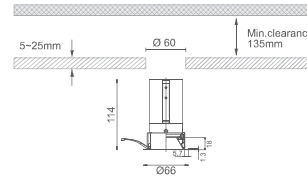

Colour(Front ring)

- Standard
- Non-standard
- WHITE
- BLACK

IP rate

- Standard
- Non-standard
- IP20
- IP54

CCT

- Standard
- Non-standard
- 2700K
- 3000K
- 3500K
- 4000K
- 5000K
- 2700-6000K
- 1800-4000K
- DTW 1800-3000K

Control

- Standard
- Non-standard
- ON/OFF
- DALI
- 0/1-10V
- TRIAC
- BLUETOOTH
- ZIGBEE
- CASAMBI

Optical Accessories

When E01 is selected, the protection level is IP20;
Choosing E02, E03, or E04 can achieve IP54 protection level;
You can choose one or both: E01+E02, E01+E03, or E01+E04.

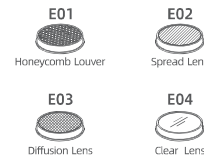

LED 10W/12W (CITIZEN LED)

LED Power	System Power	LED Output	System Output	Beam	CCT	CRI	Drive
9.5W	10.5W	951lm	639lm	15°	3000K	> 90	32V 300mA
10W	11.5W	1320lm	843lm	24°	3000K	> 90	34V 300mA
10W	11.5W	1320lm	976lm	36°	3000K	> 90	34V 300mA
10W	11.5W	1320lm	905lm	45°	3000K	> 90	34V 300mA
10W	11.5W	1320lm	885lm	55°	3000K	> 90	34V 300mA
11.5W	12.5W	1087lm	695lm	15°	3000K	> 90	32V 350mA
12W	14W	1650lm	1037lm	24°	3000K	> 90	34V 350mA
12W	14W	1650lm	1142lm	36°	3000K	> 90	34V 350mA
12W	14W	1650lm	1116lm	45°	3000K	> 90	34V 350mA
12W	14W	1650lm	1082lm	55°	3000K	> 90	34V 350mA

Light Distribution

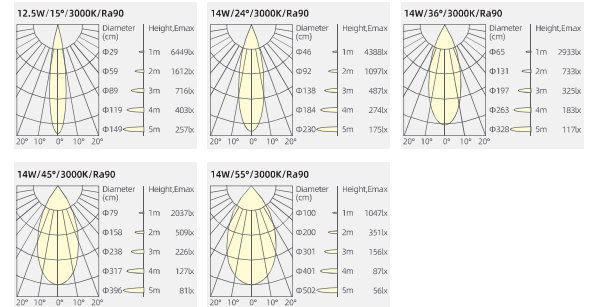

Colour(Reflector)

